

Meetings & Event Guide.

OMNI HILTON HEAD
OCEANFRONT RESORT

EXPERIENCES MATTER HERE



OMNI
HILTON HEAD

Table *of* Contents

MEETINGS & EVENTS OVERVIEW 01

ABOUT..... 02

EVENT VENUES 04

HIGHLIGHTS 06

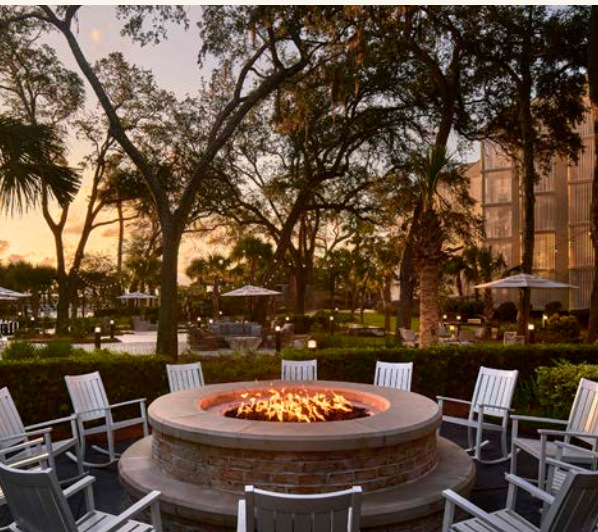

Oceanfront retreat for BUSINESS OR LEISURE.

With its beachfront location, sparkling pools, spa and championship golf courses, Omni Hilton Head Oceanfront Resort is an exceptional destination for events. Our modern hotel is located on Hilton Head Island near the regional airport for easy access. Beautifully appointed guest rooms and suites and a host of dining options and amenities ensure guests feel relaxed and invigorated, even when traveling for business.

A premier destination for business meetings and conferences, Omni Hilton Head Oceanfront Resort offers 14,000 square feet of flexible, indoor meeting space and 5,100 square feet of outdoor event and pre-function space. From the expansive Palmetto Ballroom and Sabal Rooms to the Shorehouse and Breeze Deck, we have the ideal venue for your gathering.



about Omni Hilton Head Oceanfront Resort.

THE ULTIMATE ISLAND GETAWAY

Experience the inclusive charm and relaxed ambience of Omni Hilton Head Oceanfront Resort. Discover inviting guest rooms and suites with breathtaking ocean views, make a splash in sparkling outdoor pools, pamper yourself in the spa or enjoy a round of golf on championship courses. Dine in steak and seafood restaurants, catch a sports game in the bar or sip cocktails at sunset beachside. Tucked away on Hilton Head Island, this oceanfront gem is a sanctuary of relaxation and escape.





An event to remember.

- 323 beautifully appointed guest rooms and suites, with tropical-inspired decor, modern amenities and ocean views
- Approximately 14,000 square feet of flexible indoor meeting space and 11,000 square feet of outdoor event and pre-function space; 13 rooms in total, including the grand Palmetto Ballroom, expansive meeting rooms, decks and terraces
- Fast Wi-Fi, the latest AV technology and helpful professional services
- Sparkling outdoor adult swimming pool, plus hot tubs, private poolside cabanas, family-friendly pools and splash pad
- Unique dining experiences at HH Prime serving succulent steaks and seafood. Enjoy salads, sandwiches, pizzas, burgers and fair-trade coffee at trendy Palmetto Market or craft cocktails and light bites poolside at Buoy Bar or Breeze
- Gather in the evenings to catch a sports game over dinner and drinks at XO Sports & Spirits
- Tee off on one of three award-winning golf courses designed by Arthur Hills, Robert Trent Jones and George Fazio at Palmetto Dunes
- 19 clay tennis courts and 24 illuminated pickleball courts with daily tournaments
- Balance mind, body and spirit with a relaxing facial or massage at Ocean Tides Spa
- Full-service fitness center with Peloton® bikes, treadmills and state-of-the-art equipment

Flexible Meeting Spaces.

LEVEL ONE

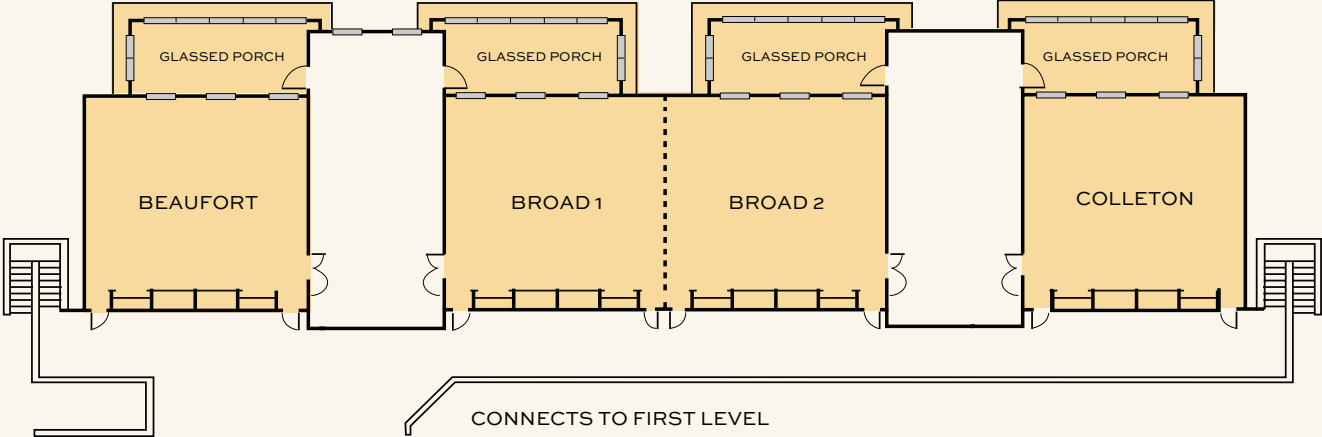

	SQUARE FOOTAGE	DIMENSIONS	CEILING HEIGHT	THEATER	CLASSROOM	BANQUET	CONFERENCE	RECEPTION
LEVEL ONE								
BEAUFORT	980	28' x 35'	9'2"	111	57	80	24	-
BROAD 1 & 2	1,960	28' x 70'	9'2"	216	111	160	50	-
BROAD 1	980	28' x 35'	9'2"	111	57	80	24	-
BROAD 2	980	28' x 35'	9'2"	111	57	80	24	-
COLLETON	980	28' x 35'	9'2"	105	57	70	24	-
RIVER ROOM GLASS PORCHES	300	-	-	-	-	-	-	-

Meeting room capacities were determined using 72" rounds of 10 (rounds capacity), three chairs per 6'X30" table (U-Shape capacity) and three chairs per 6'X18" table (Classroom capacity) allowing for minimal audiovisual equipment.

Flexible Meeting Spaces.

LEVEL TWO

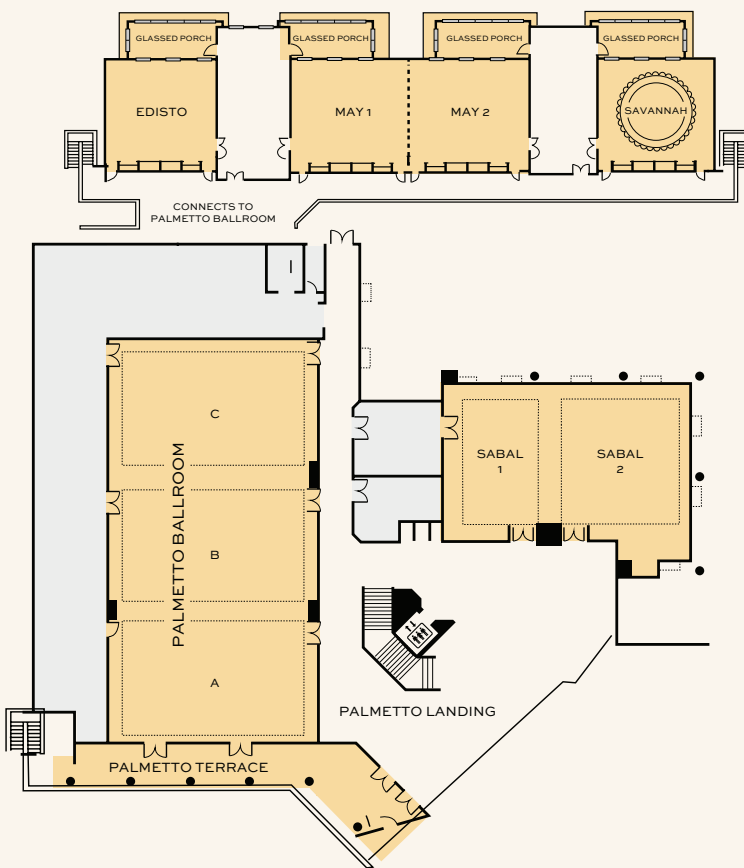

	SQUARE FOOTAGE	DIMENSIONS	CEILING HEIGHT	THEATER	CLASSROOM	BANQUET	CONFERENCE	RECEPTION
LEVEL TWO								
PALMETTO BALLROOM	3,960	88' x 45'	11'6"	483	250	320	-	-
PALMETTO BALLROOM A	1,305	29' x 45'	11'6"	144	72	100	36	-
PALMETTO BALLROOM B	1,305	29' x 45'	11'6"	144	72	100	36	-
PALMETTO BALLROOM C	1,305	29' x 45'	11'6"	144	72	100	36	-
PALMETTO BALLROOM A & B	2,655	59' x 45'	11'6"	288	147	210	-	-
PALMETTO BALLROOM B & C	2,655	59' x 45'	11'6"	288	147	210	-	-
PALMETTO LANDING AREA	-	-	-	-	-	-	-	300
SABAL 1 & 2	1,904	58' x 34'	9'7"	211	108	150	50	-
SABAL 1	816	24' x 34'	9'7"	88	45	60	18	-
SABAL 2	1,088	32' x 34'	9'7"	122	83	90	30	-
EDISTO	980	28' x 35'	10'0"	105	57	70	24	-
MAY 1 & 2	1,960	28' x 70'	10'0"	216	111	160	50	-
MAY 1	980	28' x 35'	10'0"	105	57	70	24	-
MAY 2	980	28' x 35'	10'0"	105	57	70	24	-
SAVANNAH (BOARDROOM)	980	28' x 35'	10'0"	-	-	-	27	-
SHOREHOUSE OCEANFRONT DECK	5,000	80' x 62'	10'0"	-	-	350	-	-
RIVER ROOM GLASS PORCHES	300	-	-	-	-	-	-	-

Meeting room capacities were determined using 72" rounds of 10 (rounds capacity), three chairs per 6'X30" table (U-Shape capacity) and three chairs per 6'X18" table (Classroom capacity) allowing for minimal audiovisual equipment.



OMNI HILTON HEAD OCEANFRONT RESORT
23 OCEAN LANE, HILTON HEAD, SOUTH CAROLINA 29928

[OMNIHOTELS.COM/HILTON-HEAD](https://omnihotels.com/hilton-head)



Hilton Head

highlights.

A PLACE TO MEET OR CELEBRATE

Nestled on idyllic Hilton Head Island in South Carolina, Omni Hilton Head Oceanfront Resort boasts access to sun-kissed beaches, 11 miles of lagoon trails, sparkling pools, tennis courts, a wellness spa and golf courses. Discover Shelter Cove Towne Center or specialty shops at Coligny Plaza nearby. Enjoy kayaking, cycling or hiking through verdant forest preserves and coastal parks or step inside museums and art centers on Hilton Head Island.

AIRPORTS

Hilton Head Island Airport (HHH) | 14 mins

Savannah/Hilton Head International Airport | 1 hour 10 mins

ATTRACTIONS

Shelter Cove Towne Center | 6 mins

Coligny Plaza | 11 mins

Sea Pines Forest Preserve | 11 mins

Historic Mitchelville Freedom Park | 15 mins

Coastal Discovery Museum | 16 mins

SPORTS

Palmetto Dunes Golf | 3 mins

Shelter Cove Harbour & Marina | 7 mins

Adventure Hilton Head | 15 mins

ARTS & CULTURE

Arts Center of Coastal Carolina | 4 mins

Hilton Head Symphony Orchestra | 11 mins

The Sandbox Children's Museum | 11 mins



OMNI HILTON
HEAD

OMNIHOTELS.COM/HILTON-HEAD
HLTNHD.LEADS@OMNIHOTELS.COM